

4. Find the **perimeter** by first measuring with a ruler.

a.

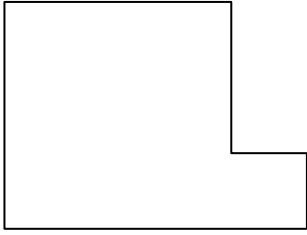

b.

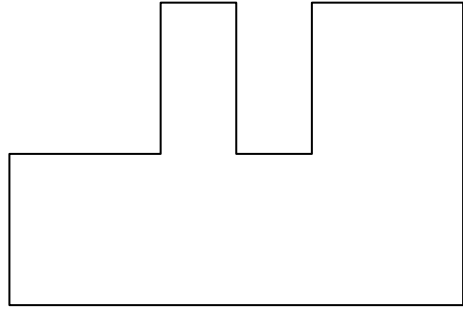

.....

.....

5. Find the area of the following triangles by using the formula $A = B \times PH \div 2$.

(a)

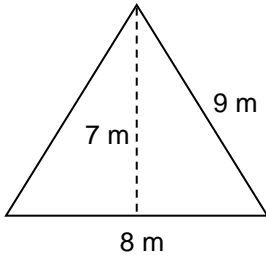

(b)

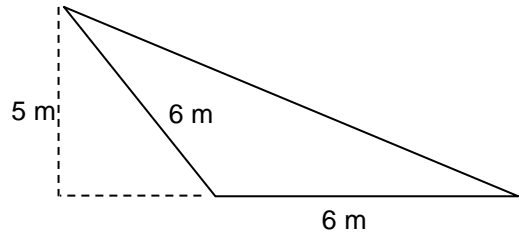

.....

.....

6. Find the area of the following triangles by first measuring the length and width. Then use the formula $A = B \times PH \div 2$.

(a)

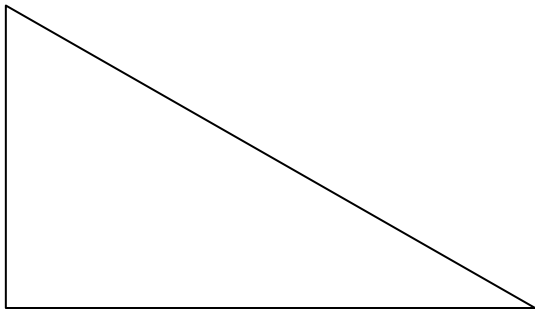

(b)

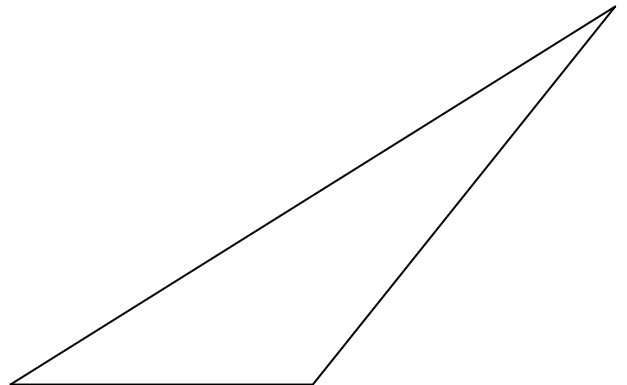

.....

.....

